

ACCESSORY SETUP INSTRUCTION

REAR BUMPER ASSEMBLY -- PN: 9AWV-801200-8000

VALID FOR: MY2024 and Newer CFORCE 800 TOURING (G3) & CFORCE 1000 TOURING (G3)

BEFORE YOU BEGIN: Read and understand the instructions before starting any work. Make sure that all parts are ready and that you have all the tools required for assembly.

NOTE: CFMOTO shall not be liable for any damage caused by incorrect assembly. CFMOTO recommends that all original accessories be assembled by an authorized CFMOTO dealer.

Before assembly, park the vehicle on a flat surface, put the transmission gear into Park (P) and turn off the key switch.

Zhejiang CFMOTO Power Co., Ltd. All rights reserved. Reproduction of this document, even in part, as well as copying of all kinds, is permitted only with the express written permission of the copyright owner.

MEANING OF SYMBOLS



- Indicates information with more details or tips.



- Indicates information of warning or danger.

PARTS LIST:

ITEM	PART NAME	PART NUMBER	QTY.	REMARK
1	Rear Bumper Assembly	9AWV-801200-8000	1	For structure reference only
2	Rear Bumper	9AWL-235000-8000	1	

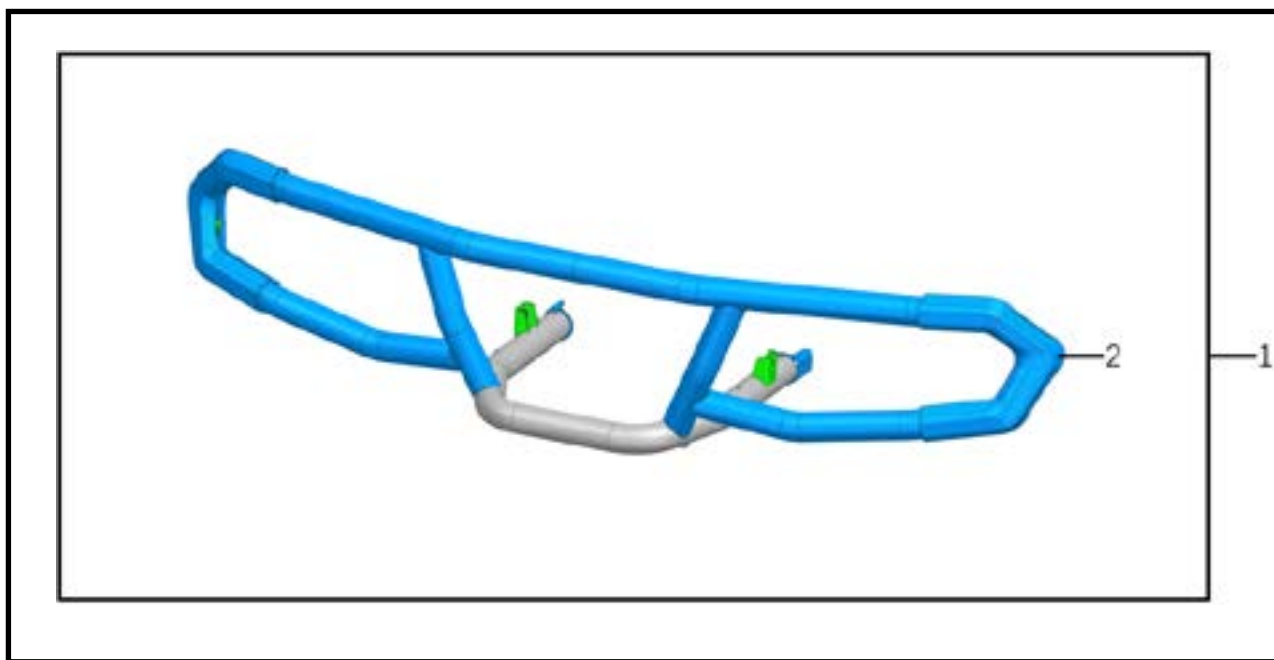

TOOL LIST:

ITEM	DESCRIPTION	QTY.	REMARK
1	ELECTRIC WRENCH	1	Recommended tools, which are not included in the package.
2	INNER HEXAGON SOCKET T30	1	
3	SOCKET s=10	1	
4	SOCKET s=13	1	
7	OPEN END WRENCH s=10	1	
8	OPEN END WRENCH s=13	1	
10	PROTECTIVE GLOVES	1	

ASSEMBLY AND INSTALLATION

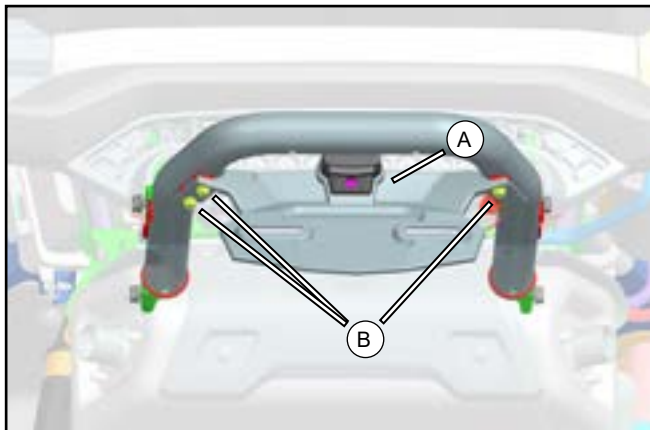

// Unscrew three M6x12 bolts (B), then take out the rear license frame (A).

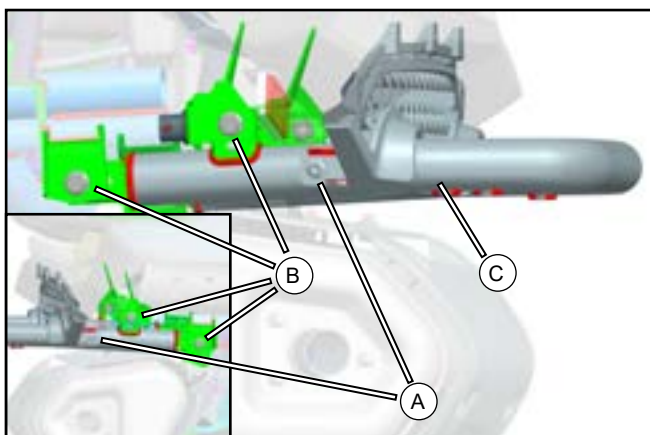

// Unscrew two M6x14 screws (A), then take out four M8x16 bolts (B). The rear bumper (C) can then be disassembled.

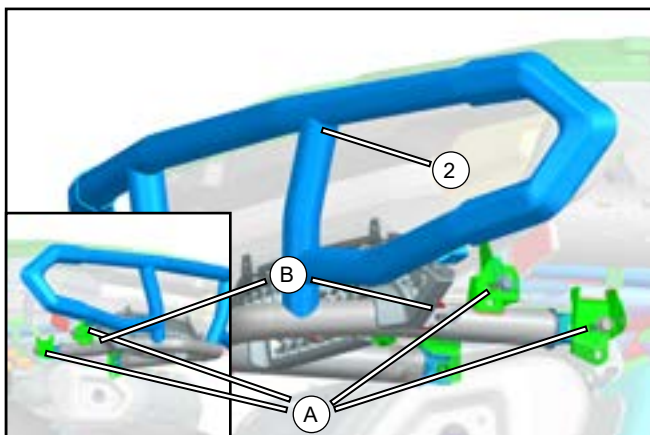

// Place the Rear Bumper Assembly (2) into position. Secure the bumper with four M8x16 bolts (A) first, then secure the remaining two M6x14 screws (B).

ASSEMBLY AND INSTALLATION

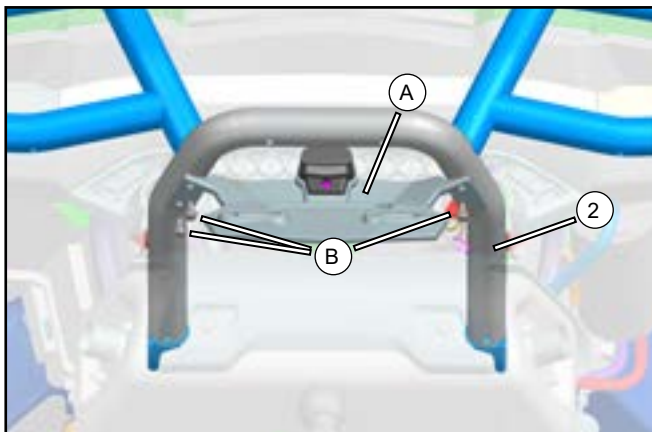

// Place the license frame (A) into position on the Rear Bumper Assembly (2) and secure it with three M6x12 bolts (B).

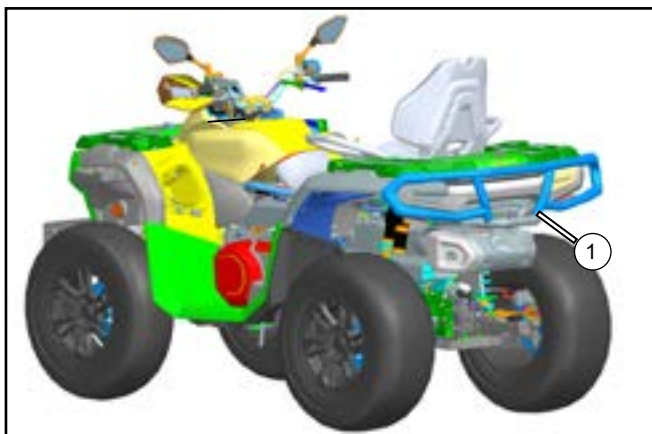

// The installation of the Rear Bumper Assembly (1) is completed.